

## Salice Series 200 hinges

### Technical information

The Salice Series 200 makes up an integrated system of hinges developed to provide a solution to any situation involving concealed hinges. Bright nickel plated steel cup and arm. Dimensions of the cup: 35mm diameter.

Constant "L" value of 0.7mm (it does not change during side adjustment)

Approx. number of hinges required according to the door dimension and weight.

(it does not change during side adjustment)

Approx. number of hinges required according to the door dimension and weight.

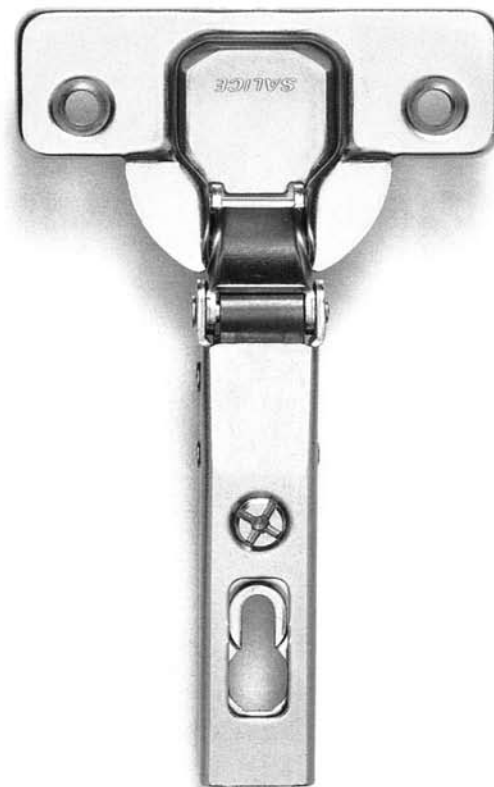
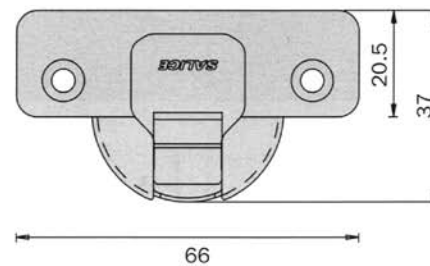
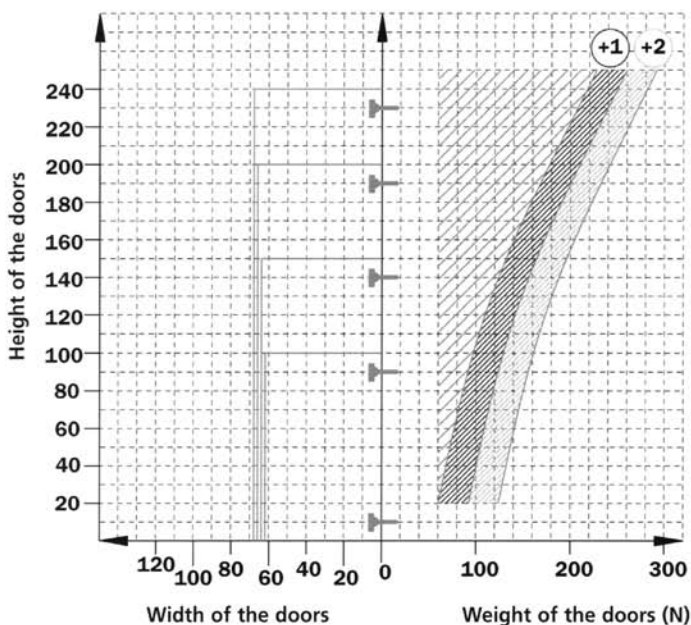

### Adjustments

Compensating side adjustment -1.5mm +4.5mm.  
Height adjustment +/-2mm.  
Depth adjustment with Series 200 mounting plates +2.8mm.  
Depth adjustment with DOMI snap-on mounting plates -0.5 +2.8mm.

### Mounting plates

Series 200 with traditional assembly, with predetermined stop, available in steel or diecast, symmetrical and assymetrical.

Snap-on assembly on Series DOMI® snap-on mounting plates. Straight symmetrical mounting plates in black nylon.

P.S. Use Posidrive No.2 screwdrivers for all screws.

# Concealed Hinges

## Salice Series 200 hinges 94°

### Technical information

For thick doors up to 32mm, with special profiles

For inset doors

11mm deep metal cup

94° opening

Possible drilling distance on the door (K): from 3 to 8mm

Compatible with all Series 200, 700 traditional mounting plates and with all DOMI® snap-on mounting plates.

### Space needed to open the door:

T=	16	18	20	22	24	26	28	30	32
K=3 A=	0.4	0.8	1.2	1.7	2.4	3.2	4.5	6.3	8.1
K=4 A=	0.4	0.7	1.2	1.7	2.3	3.1	4.2	5.6	7.5
K=5 A=	0.4	0.7	1.1	1.6	2.3	3.0	3.9	5.3	7.0
K=6 A=	0.4	0.7	1.1	1.6	2.2	2.9	3.8	5.0	6.5
K=7 A=	0.4	0.7	1.1	1.6	2.1	2.8	3.7	4.7	6.1
K=8 A=	0.4	0.7	1.1	1.5	2.1	2.8	3.6	4.5	5.8

K=	3	4	5	6	7	8
L=	0.0	0.0	0.0	0.0	0.1	1.1

The above values are calculated on the assumption that the doors have square edges.

They are reduced if the doors have radius edges.

Code	Description	Hinge cup fixing
098253	94° clip-on Arm 0 (CA)	Screw on/B pattern
098239	94° clip-on Arm 9 (CA)	Screw on/B pattern
098206	94° clip-on Arm 17 (CA)	Dowel/B pattern
098226	94° clip-on Arm 17 (CA)	Screw on/B pattern
098032	94° clip-on Arm 17 (CA)	Rapido/B pattern

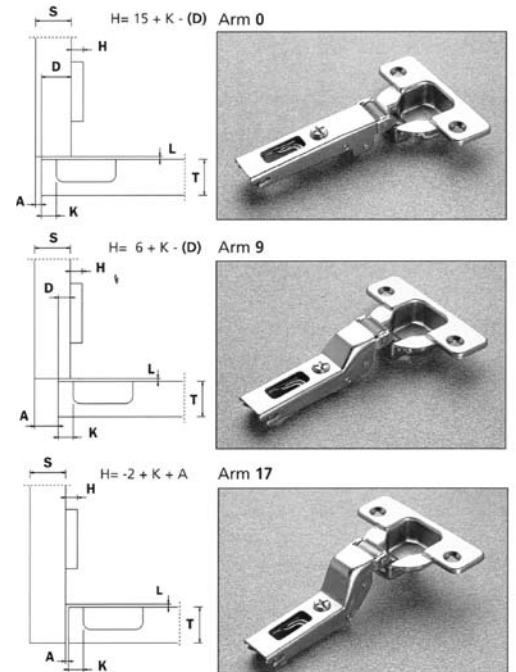
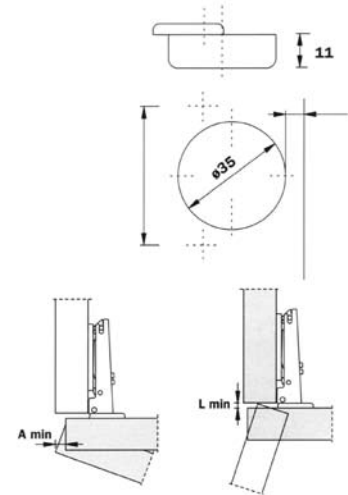
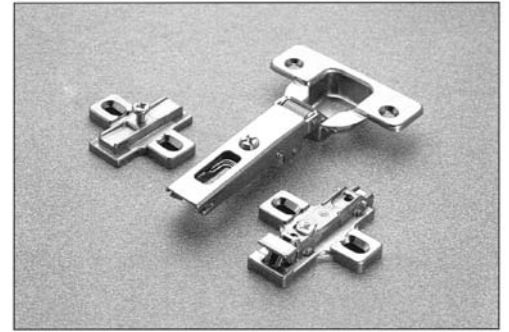

## Salice hinge drillings and fixings

**OVERLAY DOOR**

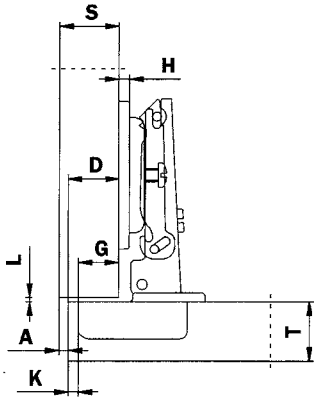

**HALF OVERLAY DOOR**

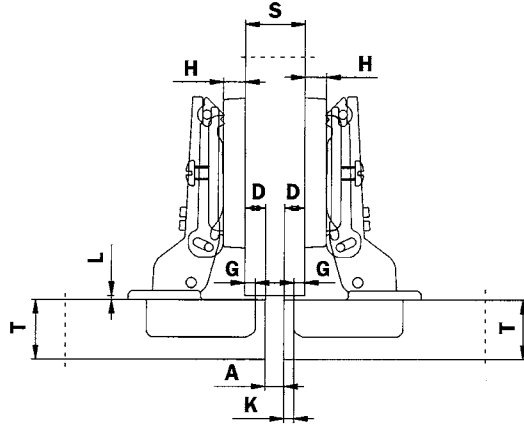

**INSET DOOR**

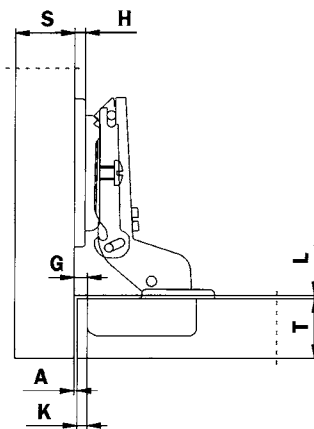

**'I' PATTERN**

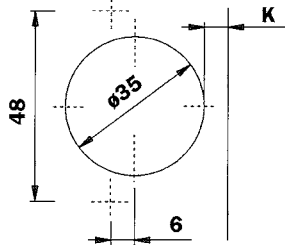

**'B' PATTERN**

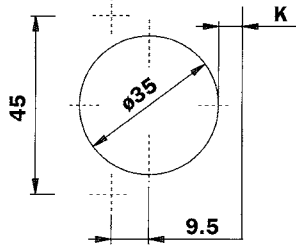

**'H' PATTERN**

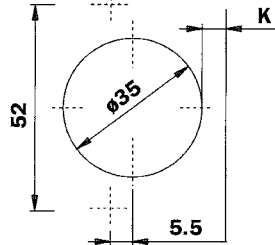

**Screw-on**

Premounted wood screw

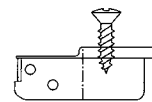

Screws not included

**'I' PATTERN**

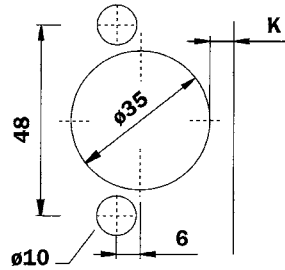

**'B' PATTERN**

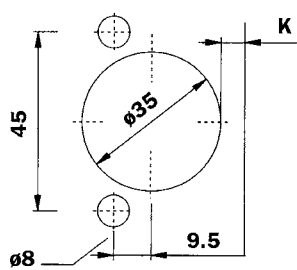

**'H' PATTERN**

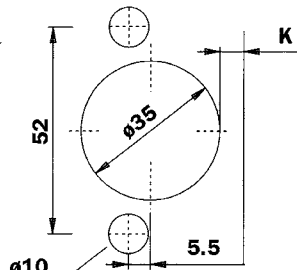

**Knock-in Dowel**

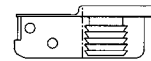

**'I' PATTERN**

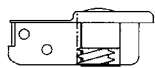

**'B' PATTERN**

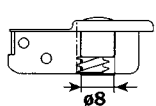

**'H' PATTERN**

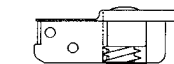
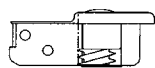

**Rapido**

**'I' PATTERN**

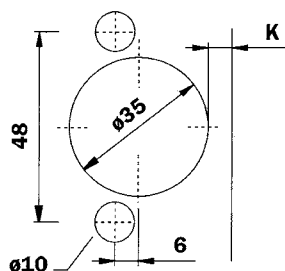

**Logica**

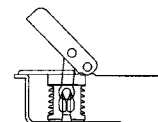

## Sideways adjustment of the door with Series 200, 700 and F hinges

An ingenious adjustment system allows the door to be moved sideways without changing the gap behind the door ( the "L" value of 0.7mm remains constant).

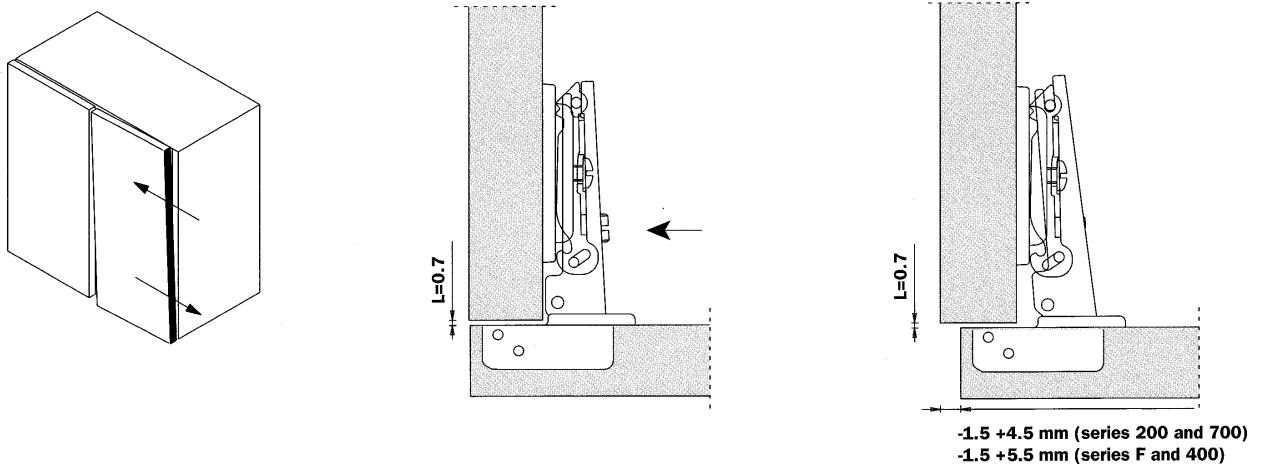

## Depth adjustment for Domi® Snap-on Mounting Plates

Depth adjustment is made without loosening any screws. The door can be moved frontally by  $-0.5 +2.8$ mm simply by rotating the cam adjuster in this range of mounting plates.

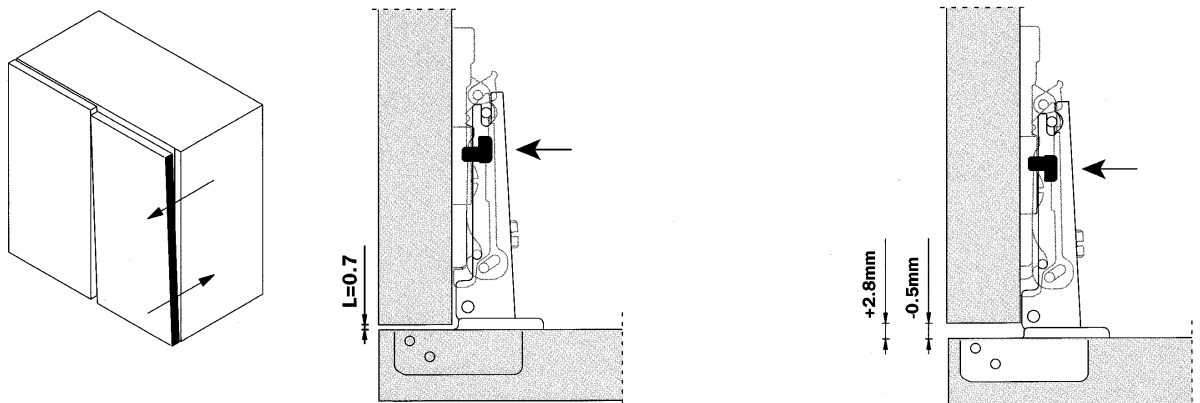

## Traditional Height adjustment

By loosening the two fixing screws it is possible to adjust the door vertically by  $\pm 2$ mm. The oval holes allow the mounting plate to slide freely in both directions. Finally the screws must be retightened.

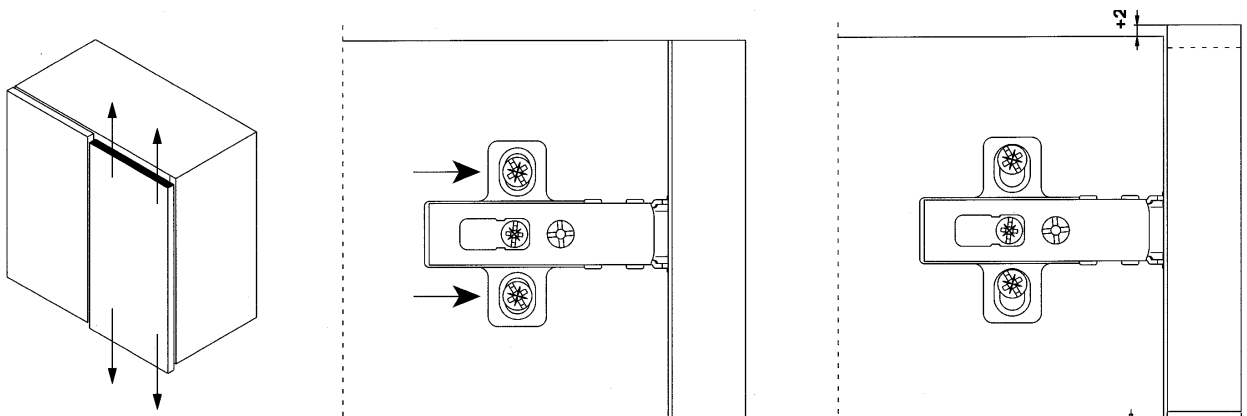

## Salice Series 200 hinges 110°

### Technical information

When a greater opening angle is required

11mm deep metal cup

110° opening

Possible drilling distance on the door (K): from 3 to 6mm

Compatible with all Series 200, 700 traditional mounting plates and with all DOMI® snap-on mounting plates.

### Space needed to open the door:

T=	16	17	18	19	20	21	22	23	24	25	26
K=3 A=	0.5	0.7	0.9	1.2	1.5	1.8	2.4	3.7	5.1	6.5	7.8
K=4 A=	0.5	0.7	0.9	1.2	1.5	1.8	2.1	2.7	4.1	5.5	6.8
K=5 A=	0.5	0.7	0.9	1.2	1.5	1.8	2.1	2.6	3.1	4.1	5.4
K=6 A=	0.5	0.7	0.9	1.2	1.5	1.8	2.1	2.5	3.0	3.5	4.4

T=	16	17	18	19	20	21	22	23	24	25	26
K=3 L=	0.0	0.0	0.0	0.0	0.2	0.5	0.8	1.1	1.4	1.7	1.9
K=4 L=	0.0	0.0	0.3	0.6	0.9	1.2	1.4	1.7	2.0	2.3	2.6
K=5 L=	1.1	1.3	1.6	1.8	2.1	2.3	2.6	2.9	3.1	3.4	3.6
K=6 L=	2.0	2.3	2.5	2.8	3.1	3.3	3.6	3.8	4.1	4.3	4.6

The above values are calculated on the assumption that the doors have square edges.  
They are reduced if the doors have radius edges.

Code	Description	Hinge cup fixing
098221	110° clip-on Arm 0 (CL)	Screw on/B pattern
098222	110° clip-on Arm 0 (CA)	Dowel/B pattern
098030	110° clip-on Arm 0 (CA)	Rapido/B pattern

Code	Description	Hinge cup fixing
098203	94° clip-on Arm 9 (CA)	Screw on/B pattern
098224	94° clip-on Arm 9 (CA)	Dowel/B pattern
098031	94° clip-on Arm 9 (CA)	Rapido/B pattern

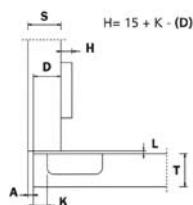
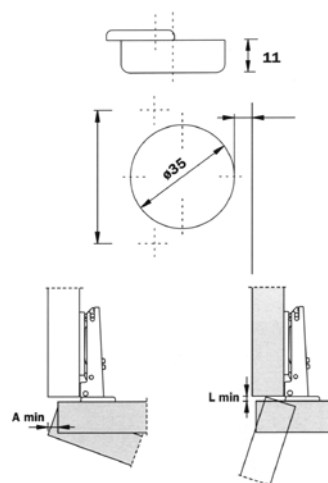
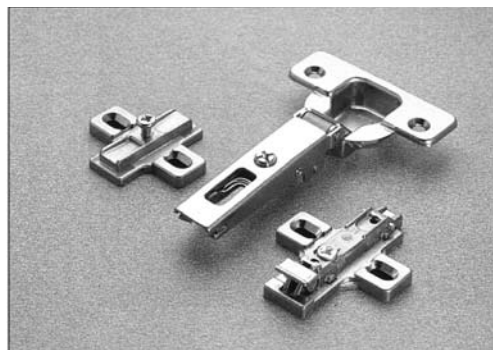

Arm 0

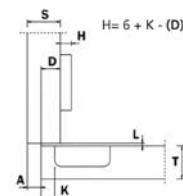

Arm 9



## Salice Series 200 hinges 165°

### Technical information

Hinge with greater opening angle and reduced operating profile.

11 mm deep die-cast cup

165° opening

Possible drilling distance on the door (K): from 3 to 8mm

Compatible with all Series 200, 700 traditional mounting plates and

with all DOMI® snap-on mounting plates.

### Space needed to open the door:

T=	16	18	20	22	24	26	28
k=3 A=	0.0	0.0	0.0	0.7	2.7	4.6	7.9
k=4 A=	0.0	0.0	0.0	0.1	1.8	3.8	6.9
k=5 A=	0.0	0.0	0.0	0.1	1.2	3.0	5.9
k=6 A=	0.0	0.0	0.0	0.1	0.9	2.5	4.9
k=7 A=	0.0	0.0	0.0	0.1	0.7	2.0	3.9
k=8 A=	0.0	0.0	0.0	0.1	0.6	1.7	3.2

The above values are calculated on the assumption that the doors have square edges. They are reduced if the doors have radius edges.

Code	Description	Hinge cup fixing
098231	165° clip-on Arm 0 (CL)	Screw on/B pattern
098232	165° clip-on Arm 0 (CA)	Dowel/B pattern
098033	165° clip-on Arm 0 (CA)	Rapido/B pattern

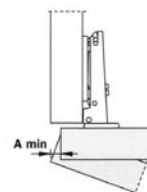
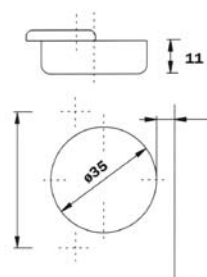
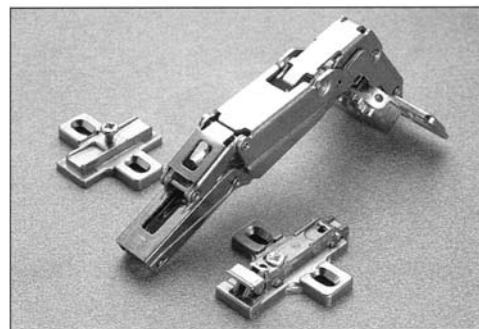

Arm 0

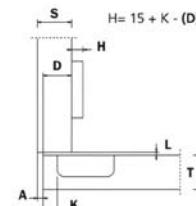

## Salice Glass Door hinges 94°

### Technical information

Possible drilling distance on the door (K): from 5.5 to 6.5mm

Hole diameter 26mm

94° opening

For use with glass of 4 to 6mm thickness

Compatible with all Series 200, 700 traditional mounting plates and

with all DOMI® snap-on mounting plates.

Use these formulas to determine the type of hinge arm, the door

drilling "K" and the height of the mounting plate "H" which is

necessary to solve each application problem.

Code	Description	Hinge cup fixing
098241	94° clip-on Arm 0 (CA)	Screw on

Code	Description	Hinge cup fixing
098242	94° clip-on Arm 9 (CA)	Screw on

Code	Description	Hinge cup fixing
098243	94° clip-on Arm 17 (CA)	Screw on

Code	Description	Finish
098244	Round cover cap	Chrome

098247	D cover cap	Chrome
--------	-------------	--------

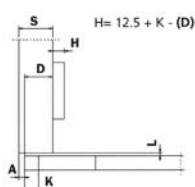
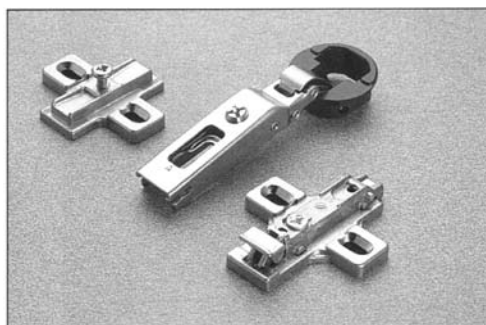

Arm 0

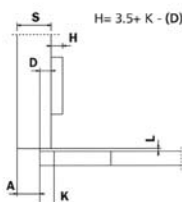

Arm 9

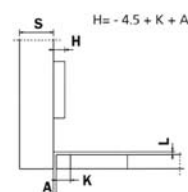

Arm 17



## Salice Positive Angle Hinges

### Technical information

11mm deep metal cup

Possible drilling distance on the door (K): from 3 to 8mm

Compatible with all Series 200, 700 traditional mounting plates and with all DOMI® snap-on mounting plates.

Use these formulas to determine the type of hinge arm, the door drilling "K" and the height of the mounting plate "H" which is necessary to solve each application problem.

Code	Description	Hinge cup fixing
<b>098252</b>	<b>Arm 15° (2AZ) clip-on (CA)</b>	<b>Screw on B pattern</b>

Code	Description	Hinge cup fixing
<b>098262</b>	<b>Arm 24° (2AU) clip-on (CA)</b>	<b>Screw on B pattern</b>

Code	Description	Hinge cup fixing
<b>098254</b>	<b>Arm 30° (2AE) clip-on (CA)</b>	<b>Screw on B pattern</b>

Code	Description	Hinge cup fixing
<b>098261</b>	<b>Arm 30° (2AT) clip-on (CA)</b>	<b>Screw on B pattern</b>

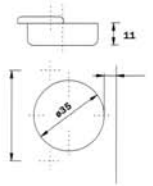
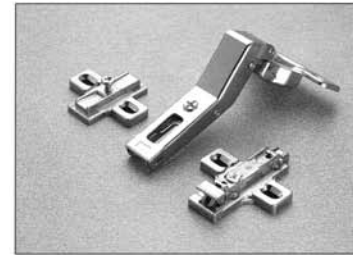

Arm 15°

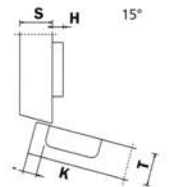

Arm 24°

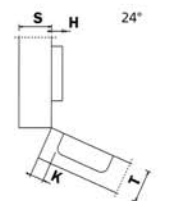

Arm 30°

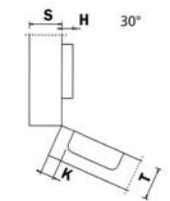

Arm 30°

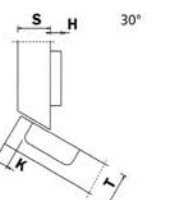

## Salice Positive Angle Hinges

Code	Description	Hinge cup fixing
098257	Arm 37° (2AK) clip-on (CA)	Screw on B pattern

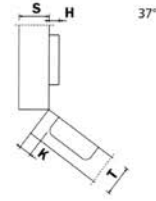

37°

Arm 37°



Code	Description	Hinge cup fixing
098207	Arm 45° (2AM) clip-on (CA)	Screw on B pattern

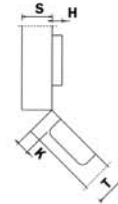

45°

Arm 45°



098208	Arm 45° (2AM) clip-on (CA)	Dowel B pattern
--------	----------------------------	-----------------

098228	Arm 45° (2AM) clip-on (CA)	Dowel B pattern
--------	----------------------------	-----------------

098288	Arm 45° (2AM) clip-on (CA)	Dowel B pattern
--------	----------------------------	-----------------

Code	Description	Hinge cup fixing
098251	Arm 45° overlay(2AV) (CA)	Screw on B pattern

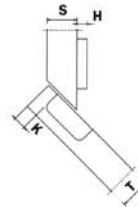

45°

Arm 45°



Code	Description	Hinge cup fixing
098260	Arm 45° (2AMC) clip-on (CA)	Screw on B pattern

098227	Arm 45° (2AMC) clip-on (CA)	Rapido B pattern
--------	-----------------------------	------------------

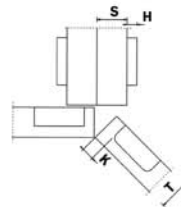

45°

Arm 45°



## Salice Negative Angle Hinges

### Technical information

13mm deep metal cup  
Possible drilling distance on the door (K): from 3 to 6mm  
120° opening

Compatible with all Series 200, 700 traditional mounting plates and with all DOMI® snap-on mounting plates.

Use these formulas to determine the type of hinge arm, the door drilling "K" and the height of the mounting plate "H" which is necessary to solve each application problem.

Code	Description	Hinge cup fixing
098250	Arm 30° (2AW) clip-on (CA)	Screw on B pattern

Code	Description	Hinge cup fixing
098256	Arm 45° (2AH) clip-on (CA)	Screw on B pattern

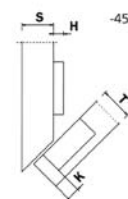
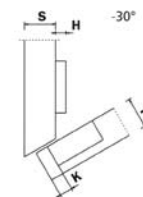
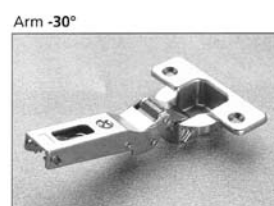
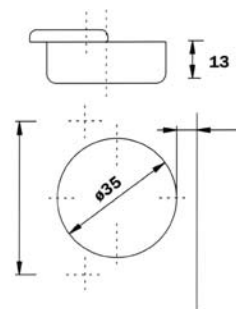

## Salice 37mm Drilling Crampon Hinges

### Technical information

11mm deep metal cup

Possible drilling distance on the door (K): from 3 to 8mm

Compatible with all Series 200, 700 traditional mounting plates and with all DOMI® snap-on mounting plates.

### Emin:

63mm for series 200 mounting plates

72mm for Domi® snap-on mounting plates

78mm for Domi® snap-on mounting plates with additional fixing hole and back cam

Code	Description	Hinge cup fixing
098230	37mm Crampon hinge (CA)	Dowel B pattern

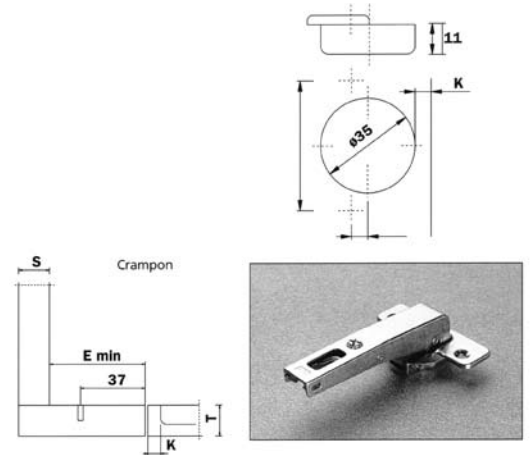

### HEIGHTS FOR BASE PLATES

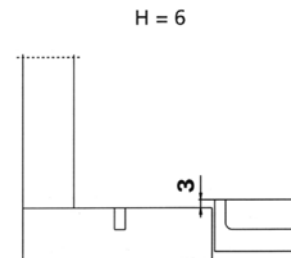
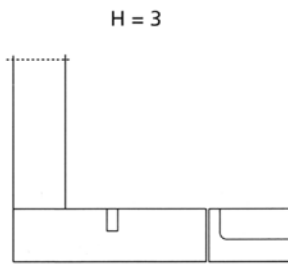
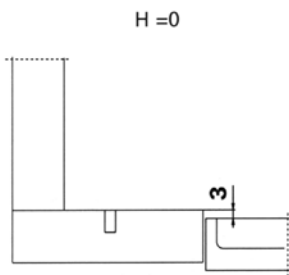

## Salice 15mm Drilling Crampon Hinges

### Technical information

11mm deep metal cup

Possible drilling distance on the door (K): from 3 to 8mm

Compatible with all Series 200, 700 traditional mounting plates Not compatible with DOMI® snap-on mounting plates.

Code	Description	Hinge cup fixing
098309	15mm Crampon hinge (CA)	Screw on B pattern
098558	Baseplate (9mm) slide on	

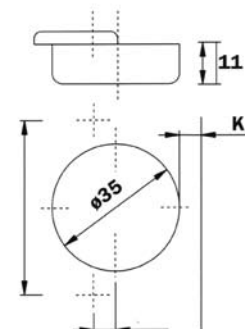
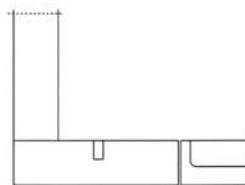
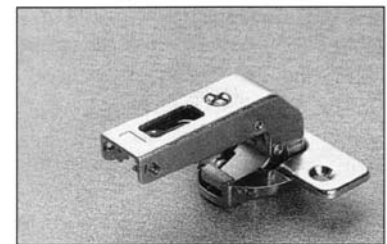

## Salice 70° Corner Door Hinges

### Technical information

11mm deep die-cast cup  
 35mm cup diameter  
 Possible drilling distance on the door (K)=4mm (fixed)  
 Opening angle of the first door 70°  
 Sprung hinge  
 Maximum thickness of the door with square edges: 23mm  
 Compatible with all Series 200, 700 traditional mounting plates and with all DOMI® snap-on mounting plates.

Code	Description	Hinge cup fixing
098237	Corner door hinge (CA)	Screw on B pattern
098238	Corner door hinge (CA)	Dowel B pattern
098034	Corner door hinge (CA)	Rapido B pattern

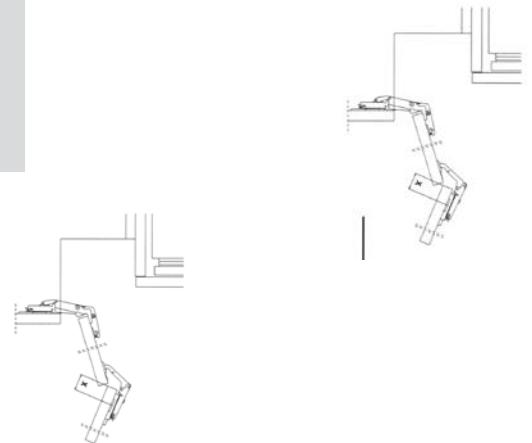
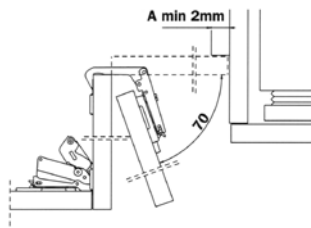
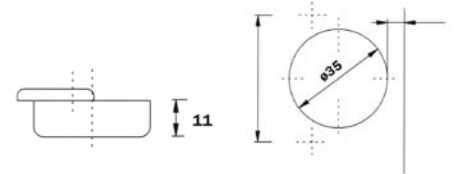

### Space needed to install hinge and plate

#### WITH CONVENTIONAL MOUNTING PLATES

The maximum space required to accommodate the hinge is 52mm with 16mm thick doors. With thicker doors the amount of space required is reduced

#### WITH DOMI SNAP-ON MOUNTING PLATES

The maximum space required to accommodate the hinge is 61mm with 16mm thick doors. With thicker doors the amount of space required is reduced

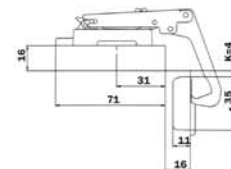
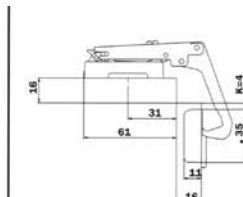
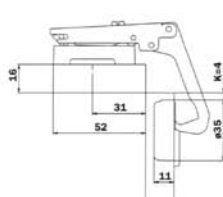

door thickness T	H mtg. plate H	side adjustment	drilling distance for cruciform mtg. plates	drilling distance for straight mounting plates
16mm	H = 6	1mm	31mm	15 + 32
17mm	H = 6	/	30mm	14 + 32
18mm	H = 4	1mm	29mm	13 + 32
19mm	H = 4	/	28mm	12 + 32
20mm	H = 3	/	27mm	11 + 32
21mm	H = 2	/	26mm	10 + 32
22mm	H = 0	1mm	25mm	9 + 32
23mm	H = 0	/	24mm	8 + 32

## Salice Low Profile Hinges - suited to fridge cabinets

### Technical information

11mm deep metal cup  
Possible drilling distance on the door (K): from 3 to 8mm

Compatible with all Series 200, 700 traditional mounting plates  
Not compatible with DOMI® snap-on mounting plates.

Code	Description	Hinge cup fixing
098219	Low Profile hinges (CA)	Screw on B pattern

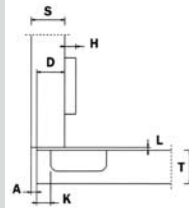
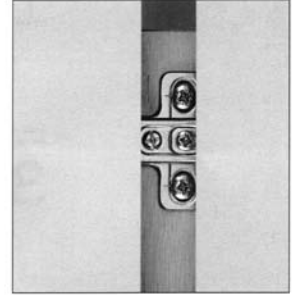
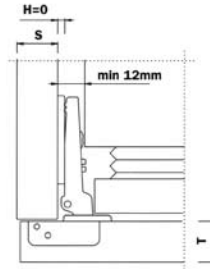
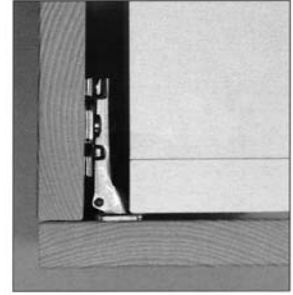
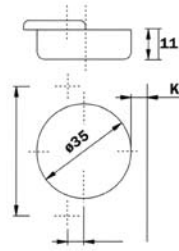

$$H = 13 + K - (D)$$

## Technical information

Hole diameter of the hinge cup 40mm.  
Bright nickel plated steel cup and die-cast arm.  
Constant ((L)) value of 0.7mm  
(it does not change during side adjustment)

Approx. number of hinges required according to the door dimension and weight.

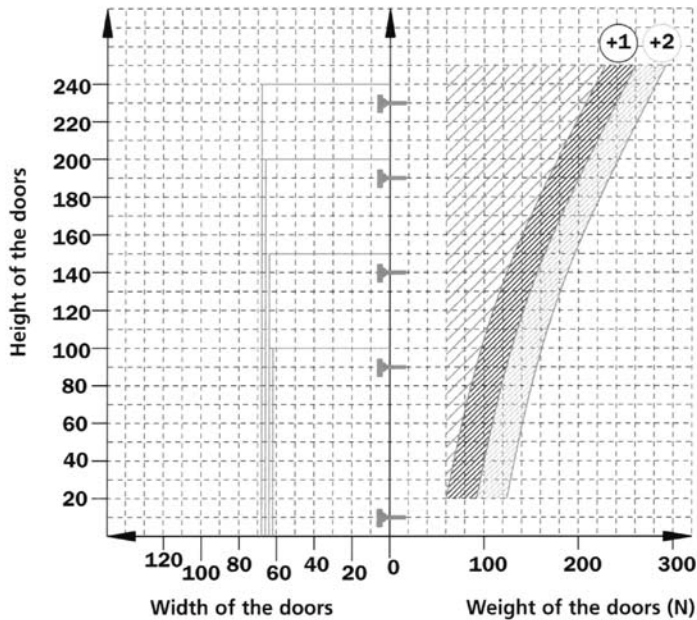

## Adjustments

Height adjustment +/- 2mm.  
Depth adjustment with Series 200 mounting plates +2.8mm.  
Depth adjustment with DOMI® mounting plates from -0.5 to +2.8mm  
Side adjustment from -0.5 to +5.5mm.

## Mounting plates

Series 200 with traditional assembly and pre-determined stop, available in steel or die-cast, symmetrical and asymmetrical.

Snap-on assembly on Series DOMI®, in steel or die-cast.

P.S. Use pozidrive No.2 screwdrivers for all screws

## Domi® Mounting Plates

DOMI® snap-on mounting plates for hinges Series 200, 700 and F  
Depth and height adjustment by cam possible

### Die-cast Mounting Plates

Code	Height (H)	Fixing
098040B	3	Premounted euro

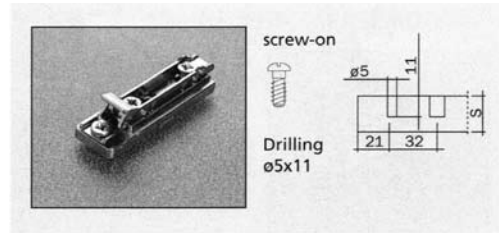

### Steel Mounting Plates

Code	Height (H)	Fixing
098530	0	Premounted euro
098533	3	Premounted euro
098534	6	Premounted euro



### Steel Mounting Plates with 5mm dowel

Code	Height (H)	Fixing
098547	0	5mm dowel & pre-mounted wood screws
098548	3	5mm dowel & pre-mounted wood screws
098549	6	5mm dowel & pre-mounted wood screws



## Domi® Face Frame Mounting Plates

DOMI® snap-on mounting plates for hinges Series 200, 700 and F  
Depth adjustment by cam

### Face Frame Mounting Plates

Code	Height (H)	Fixing
098557	1	Screw on

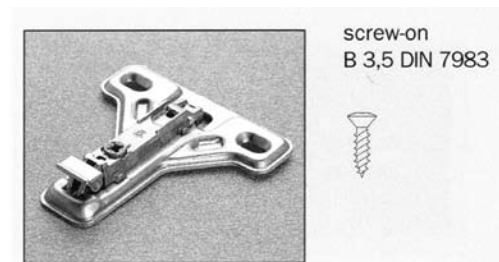

## Traditional Mounting Plates

Cruciform mounting plates for hinges Series 200, 700 and F  
Plates are die-cast

Set 15° angle

Varying angles of +10 to +30° and -7.5° opening to +7.5°

Infinite door angle applications are possible using angled mounting plates and one of Salice's range of angle arm hinges

### Die-cast Mounting Plates (A)

Code	Height (H)	Fixing
098568	12	screw on
098569	18	screw on

### Die-cast +/- 15° Mounting Plates (B)

Code	Height (H)	Fixing
098571		Screw on



### Adjustable Angle Die-cast Mounting Plates

Code	Height (H)	Fixing
098570		screw on

### Die-cast Mounting Plates

Code	Height (H)	Fixing
098572		Premounted euro

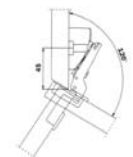
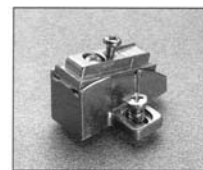
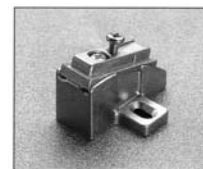

### Adjustable Angle Die-cast Mounting Plates

Code	Height (H)	Fixing
098574		screw on

### Die-cast Mounting Plates

Code	Height (H)	Fixing
098576		Premounted euro

